

EURUS Maintenance, Cleaning, and Disinfection

After each patient



1) Disinfection of Dental unit, chair, and light (except light lens).

1. Moisten a soft cloth with FD366 manufactured by Durr.
2. Wipe the product with the cloth.

CAUTION
Do not spray directly!

3. Choose a dry soft cloth and wipe the product to dry.

Daily

1) Disassembling and washing the parts marked with “ * ”



Reattachment
To reattach the drain trap, align Line with Mark▽.

Vacuum handpiece & Saliva ejector handpiece



1. Wash the surface.
2. Wash the interior and sliding part.
3. Wash the inaccessible parts with brush.
4. Autoclave

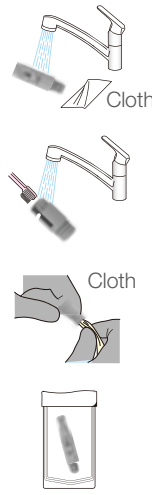

2) Flushing handpieces & cupfiller.

1. Press the function switch.
2. Insert the Handpieces.
3. Press “Flushing.”



3) Cleaning Vacuum/ Saliva ejector line.
Suction a cup of water (100ml or more).



4) Cleaning Solid collector.
Wash the components under running water.

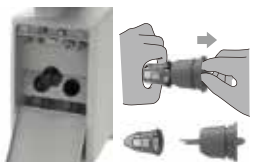

Reattachment
Align Groove with Claw.



2) Cleaning Vacuum line/Saliva ejector line.
Use Orotol plus manufactured by Durr

CAUTION
Do not use any other liquid chemical.

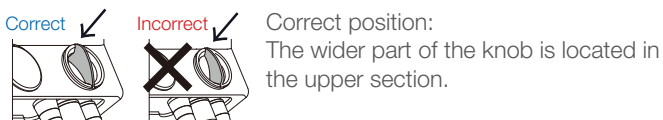

EURUS Maintenance, Cleaning, and Disinfection

Weekly

Dry soft cloth

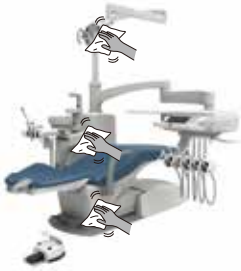

1) Cleaning for Dental Unit, Chair, and light (except Light lens).

1. Wipe with a dry soft cloth.

* If the exterior is excessively dirty, follow the steps below.



1. Moisten a soft cloth with water containing approx. 10% of natural detergent and wipe the product with the moisten cloth.

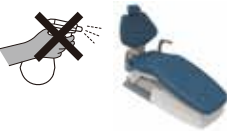

CAUTION
Do not spray directly!



2. Moisten a soft cloth with water and wipe the product.



3. Wipe the product with a dry soft cloth.

Dry soft cloth



2) Cleaning Light lens
Detache the lens cover.

1. Slide the lock lever to the right.



2. Incline the lens cover.



3. Pull it up to detach it.

Weekly



Dry soft cloth

or



Air duster

4. Lightly wipe the light lens with a soft cloth or remove any dust from the surface with an air duster.

CAUTION

Do not apply FD366 to the light lens.

Reattachment the lens cover.

5. Insert the claws of the lens cover.



5

6. Slide the lock lever to the right and hold it.

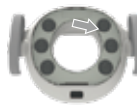

6

7. Apply the cover in contact with the light head and retrain the lever.



7

Monthly

1) Discarding the oil in the Oil mist separator.

When oil reaches to the line on the oil reservoir, discard it.



Sponge



If the hygroscopic sponge (consumable) is excessively dirty or has excessive oil, replace it.

Line

