

EURUS STOOL  
INSTALLATION INSTRUCTIONS

## Tools required for installation and attached parts

### Necessary tools

The table below shows the necessary tools for the installation of this product.

No.	Tool name	QTY
1	Phillips screwdriver No. 2,3	1 for each
2	Hex key wrench; width across flats:5mm	1

### Supplied parts



Backrest



Backrest Cover



Seat



Reclining mechanism



Frame cover



Legs



Casters (5)  
(Casters with brakes 3)



Cylinder



Cylinder cover

### Screws & bolts

- Cap bolts (M6 x 10, plated) (4)
- Pan head screws (2P M5 x 10, plated) (2)
- Pan head screws (2P M6 x 30, plated) (4)
- Flat washer (M6, plated) (4)

## Assembly procedure

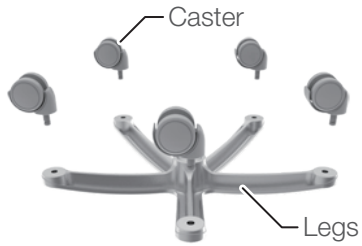

### 1. Attach the castors to the legs

3 of the 5 castors are equipped with a brake.

Attach the castors with red marks to positions marked in red on the legs.

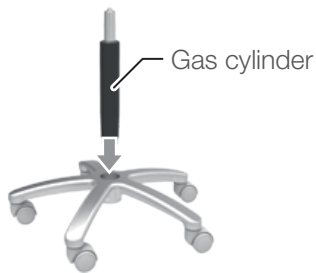

### 2. Insert the gas cylinder into the legs.

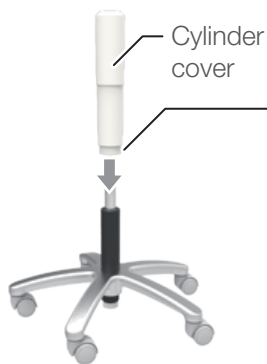

### 3. Insert the cylinder cover onto the gas cylinder.

Insert the cylinder cover until it contacts the top of the legs.



### 4. Attach the reclining mechanism to the edge of the gas cylinder.

5. Insert the frame cover onto the backrest frame.

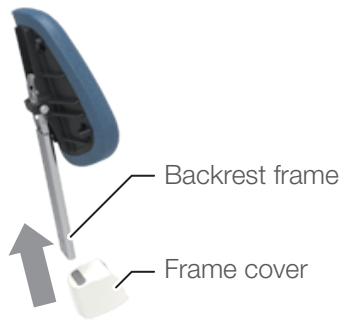

6. While raising the frame cover, attach the backrest frame to the reclining mechanism.  
Fix it into place with the 4 cap bolts (M6 x 10, plated).



7. Pull up the up/down lever and raise the reclining mechanism to the highest position.

8. Lower the frame cover, and fix it into place from below with the 2 pan head screws (2P M5 x 10, plated).

9. Put the seat on the reclining mechanism.

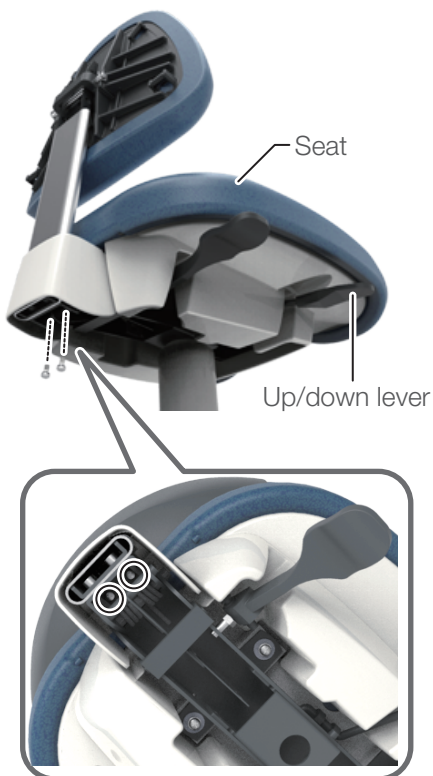



Place a flat washer onto each screw before attaching it.

10. Fix the seat into place with the following screws.  
4 pan head screws (2P M6 x 30, plated)  
Place a flat washer (M6, plated) onto each screw before tightening it.



11. Adjust the height of the backrest if necessary.  
The height of the backrest can be changed higher than the standard position: 3 cm higher or 6 cm higher.
- 1) Remove the snap pin and pull off the washer.
  - 2) While holding the backrest, pull out the shaft.
  - 3) Change the height of the backrest, insert the shaft, and put back the snap pin after placing a washer onto it.



12. Attach the backrest cover to the backrest.

Sit on the seat to deeply insert the cylinder.



13. Push in the gas cylinder.  
Apply full body weight to the seat several times so that the gas cylinder will be deeply inserted.



### Confirmation following assembly

Confirm that the seat can be raised and lowered using the up/down lever, and that the seat and backrest can be tilted using the tilt lever.

(Model AH-012A does not include the seat tilt function.)



2019-01 (First Edition)	
REF	1A0QYNAE



TAKARA BELMONT CORPORATION

2-1-1, Higashishinsaibashi, Chuo-ku, Osaka, 542-0083, Japan

TEL : 81-6-6213-5945

FAX : 81-6-6212-3680

